

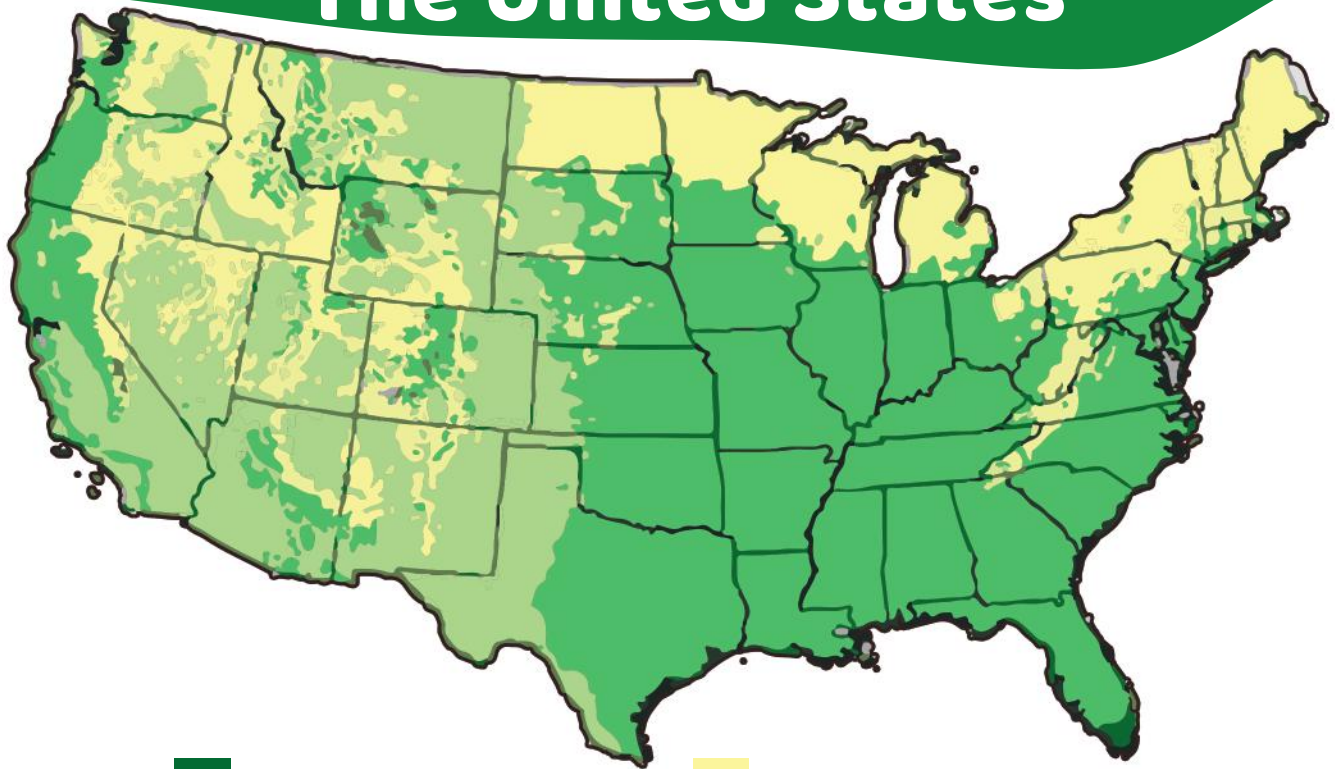

# The Different Climate Zones Of The United States



A  = Tropical Climates

D  = Moist Continental Mid-latitude Climates

B  = Dry Climates

H  = Highlands

c  = Moist Subtropical Mid-latitude Climates

The climate/climate zone of a particular region may be affected by a host of factors including the topography, vegetation, latitude, ocean currents, to name a few. The United States (U.S.) consists of five climate zones namely

## TROPICAL CLIMATES:

The Tropical Climates (represented by dark green color) is non-arid, with the average temperature being higher than 64°F throughout the year. The regions under tropical climates receive more than 59 inches precipitation annually. The region(s) in the United States with a tropical climate includes Florida (southern tip).

## DRY CLIMATES:

As indicative of the name, the dry climates (represented by light green color) have a characteristic "dry climate with little precipitation annually." Many areas of New Mexico fall under this climate zone.

## MOIST SUBTROPICAL MID-LATITUDE CLIMATES:

The moist subtropical mid-latitude climates (denoted by a shade of medium green) is characterized by humid and warm summer and relatively mild winter with little or no intense snowstorms. Georgia falls under this climate zone.

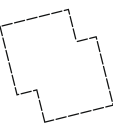

### MOIST CONTINENTAL MID-LATITUDE CLIMATES:

The moist continental mid-latitude climates (denoted by the yellow color) has a relatively "warm-cool summer." However, the winters are intense and one may experience a "below-freezing temperature (average)" during one or many of the winter months. Vermont falls under this climate zone.

### HIGHLANDS:

In highlands (Denoted by dark red color), the climatic conditions show variations with a change in altitude. For example, as altitude increases, the temperature here tends to get cooler with a significant rise in precipitation. The Rocky Mountains, the Sierra Nevada exhibit this type of climatic variation.



Match the climate zone with their characteristic feature(s)

Climate Zones	Characteristic Features
Tropical Climates	Climate changes with increase in altitude
Dry Climates	"warm-cool summer" with intense winter
Moist Subtropical Mid-latitude Climates	The average temperature is higher than 64°F throughout the year.
Moist Continental Mid-latitude Climates	humid and warm summer and relatively mild winter with little or no intense snowstorms
Highlands	dry climate with little precipitation annually

